



UPDATED  
VERSION  
SEP 2009

# WAIT

## Important Info – Read Prior to Installation

Please take a few minutes to get familiar with the overall process to help minimize difficulties and expedite a successful installation.

This faucet uses the same principles as electromagnetism, turning the spout itself into the sensor. The key to this faucet working flawlessly is to isolate the spout from any metals that will carry the magnetic field or anything that may carry electric current and interfere with its operation.

Proper installation requires the ability to follow directions. We will focus on the electronics in these instructions because we assume that you are a trained plumber. Because of this newer concept of sensor faucets, we recommend taking digital photographs of the installation before the wall is closed. This will help troubleshoot any problems that may arise if the faucet does not function properly.

### Cixx Faucet Deck Mount Version

Prior to hooking up the plumbing and electrical components, the spout should be installed on the deck through one 1-1/8" to 1-1/4" hole.



Sonoma Forge, 133 Copeland Street, Petaluma, CA 94952  
T (800) 330-5553 T (707) 789-9130 F (707)789-9201  
[www.sonomaforge.com](http://www.sonomaforge.com) [info@sonomaforge.com](mailto:info@sonomaforge.com)



UPDATED  
VERSION  
SEP 2009

## Installation Instructions

**Step 1:** Attach the water supply hoses from the water stops to the Mixing Valve. (This valve is used to adjust water temperature so should be accessible. The valve in your kit may vary)



**Step 2:** Locate where you want the Grey Sensor Module to be mounted. Attach the bracket, and slip the Module on to the bracket. The black switch on the side should be set to the full "auto" position.





UPDATED  
VERSION  
SEP 2009

**Step 3:** Supply the Sensor Module with the output of the mixing valve.  
(Make sure that the sensor module is pointing in the direction of the water flow.)

**Step 4:** Install the hose clamp with terminal connector supplied in the kit on to the all-thread below the counter, making sure that there is a tight connection between the clamp and the metal.

**Step 5:** Supply the spout with the output of the Sensor Module, making sure that there is at least 12" of non-metallic pipe or line between the Module and the Spout.

**Step 6:** Mount the Grey Battery Pack supplied. It can be mounted in any position. Mounting holes inside are exposed by opening the battery pack. It can also be mounted using heavy-duty double sided tape. Do not install batteries at this time.

**Step 7:** Connect the coiled wire from the grey battery pack to the grey sensor box.

**Step 6:** Attach the (non-coiled) black wire from the sensor box to the brass contact terminal connector on the all-thread. **Important:** Use the supplied wire connection. Do **not** cut or attempt to splice wire for a longer length. This will cause the unit to function improperly. System has a limited range determined by the wire lengths.

**Step 8:** Connect the coiled wire from the grey battery pack to the grey sensor box.

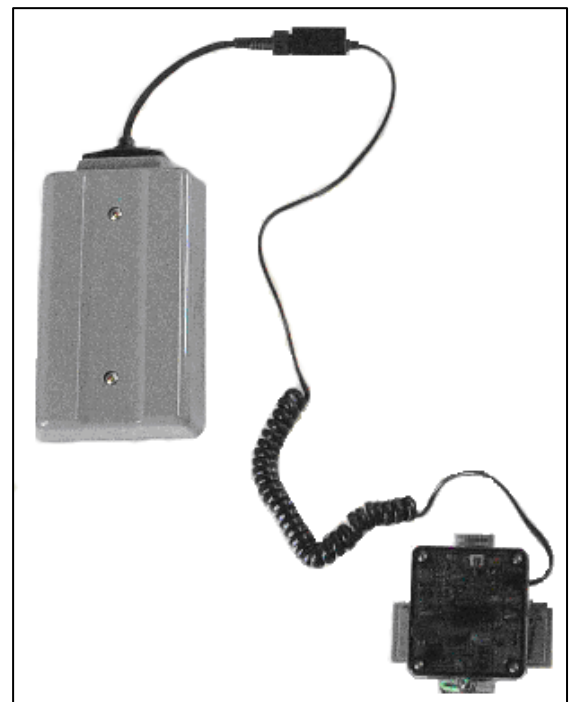
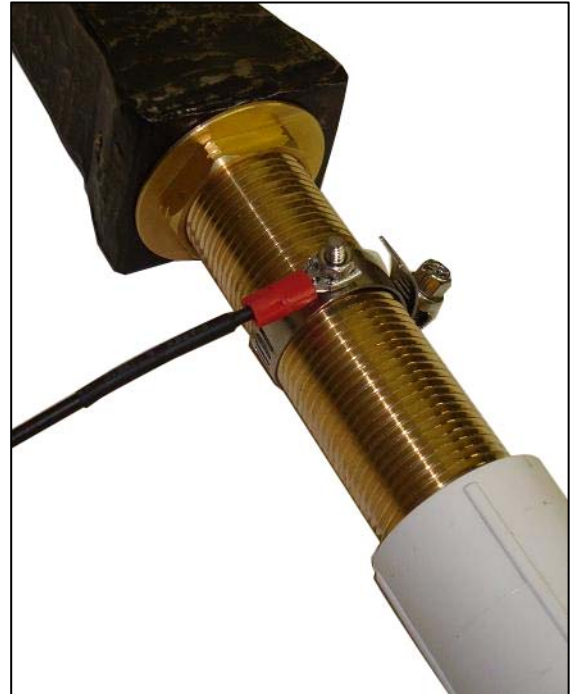



UPDATED  
VERSION  
SEP 2009

**Step 8:** To complete the electrical circuit, you must now ground the Sensor Module. Find the green and yellow wire with a hose clamp at one end. Attach this clamp/wire firmly to the cold water supply, behind the angle valve. This must have contact to the copper line and not just chrome assembly (important for establishing good ground). Attach the other end to either of the brass connector tabs located on the side of the grey sensor box.

Note: For applications using plastic supply pipe, such as PVC, one must install a grounding rod to accomplish sufficient earth ground. (See picture below – clamp on water stop not shown).



**Step 9:** Install the batteries into the battery pack. (4 “D” Alkaline Batteries – not included) Use only high quality brand name batteries. Make sure they have never been dropped, as this causes damage to the battery and decreases its lifespan.

**Step 10:** Before you turn on the water hit the reset button located on the face of the Sensor Module. The button is a round piece of rubber. You will hear the box click, indicating that the Module has been reset. Wait at least 30 seconds before continuing.

If you have made your connections correctly, the LED light will blink once every 8 seconds. Place your hands near the spout and you will hear the box click on, and then click off after removing your hands. If you do not hear the click, please review your installation.

**Step 11:** You can now turn on the water and adjust the mixing valve to the desired temperature.





UPDATED  
VERSION  
SEP 2009

**Troubleshooting: Common installation errors preventing Sans Hands from working properly.**

If the light blinks every four seconds, then the circuit is not complete and you will need to establish a better ground to earth.

If there is metal (including mirrors, metal studs, other plumbing) near the spout, it will cause the unit to function improperly. In addition, where metal sinks are used, an additional ground wire may be necessary for the drain. Contact Sonoma Forge for details and supplies (these are not included in standard Installation Kit).

Use only high quality name brand batteries to ensure long lifespan. It is important that they “never be dropped” as this can cause failure or severely decrease their lifespan. Changing batteries and/or making sure they are installed correctly should be the first remedy attempted after experiencing any issues.

Double check that the supply line to the faucet is NOT metallic.

If it blinks nonstop, it is connected incorrectly. Start over.

**Other Information:**

On the side of the Grey Sensor Module, there is a black switch with the words “Open” and “Auto” written above/below. The “Auto” setting is the correct position for normal usage. The “Open” setting is for Institutional Use Only, which allows flushing of the line if needed.



UPDATED  
VERSION  
SEP 2009

## Sensor Diagram Deck Installation

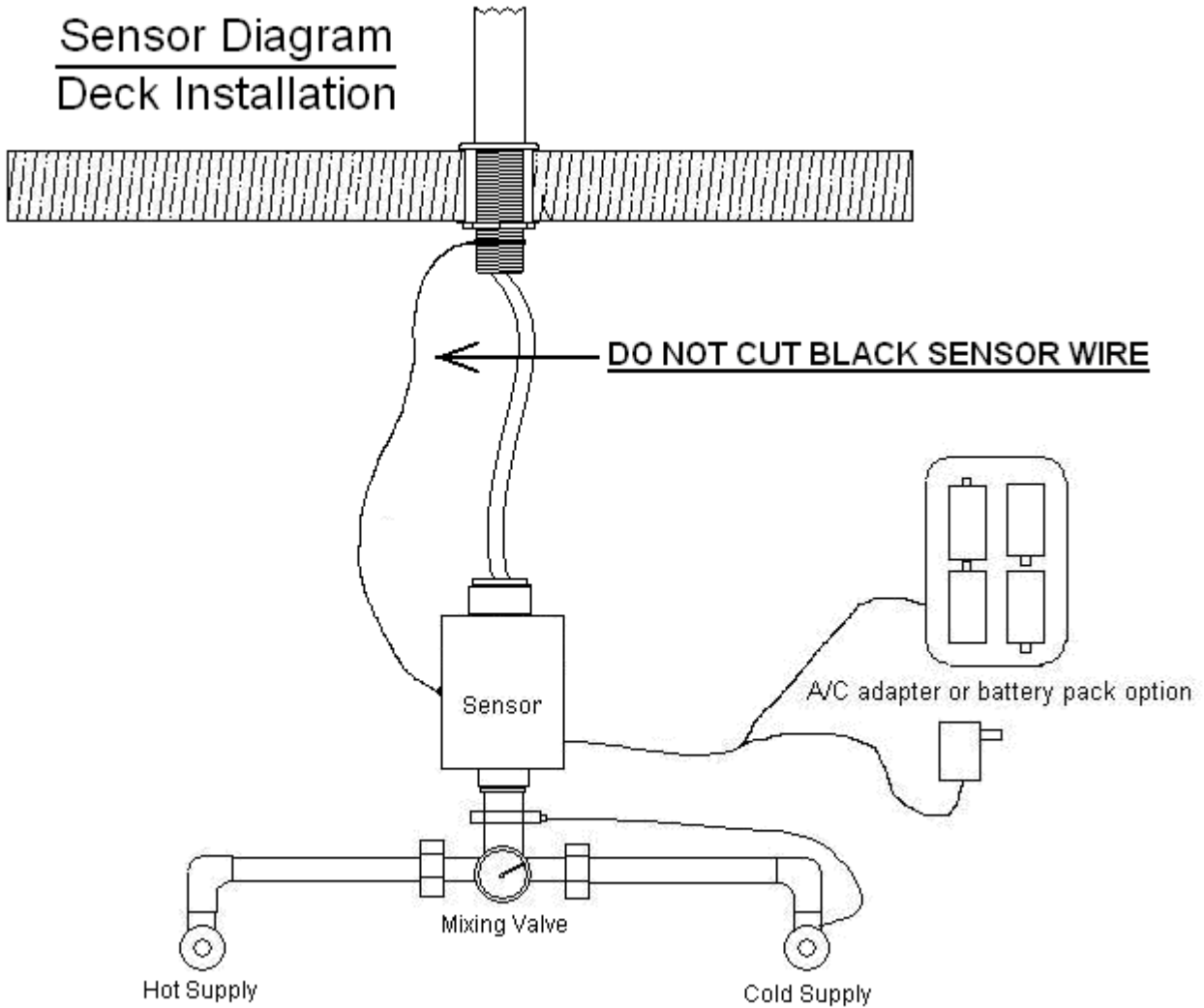



UPDATED  
VERSION  
SEP 2009

**Installation Kit Contents (some items may vary between models):**

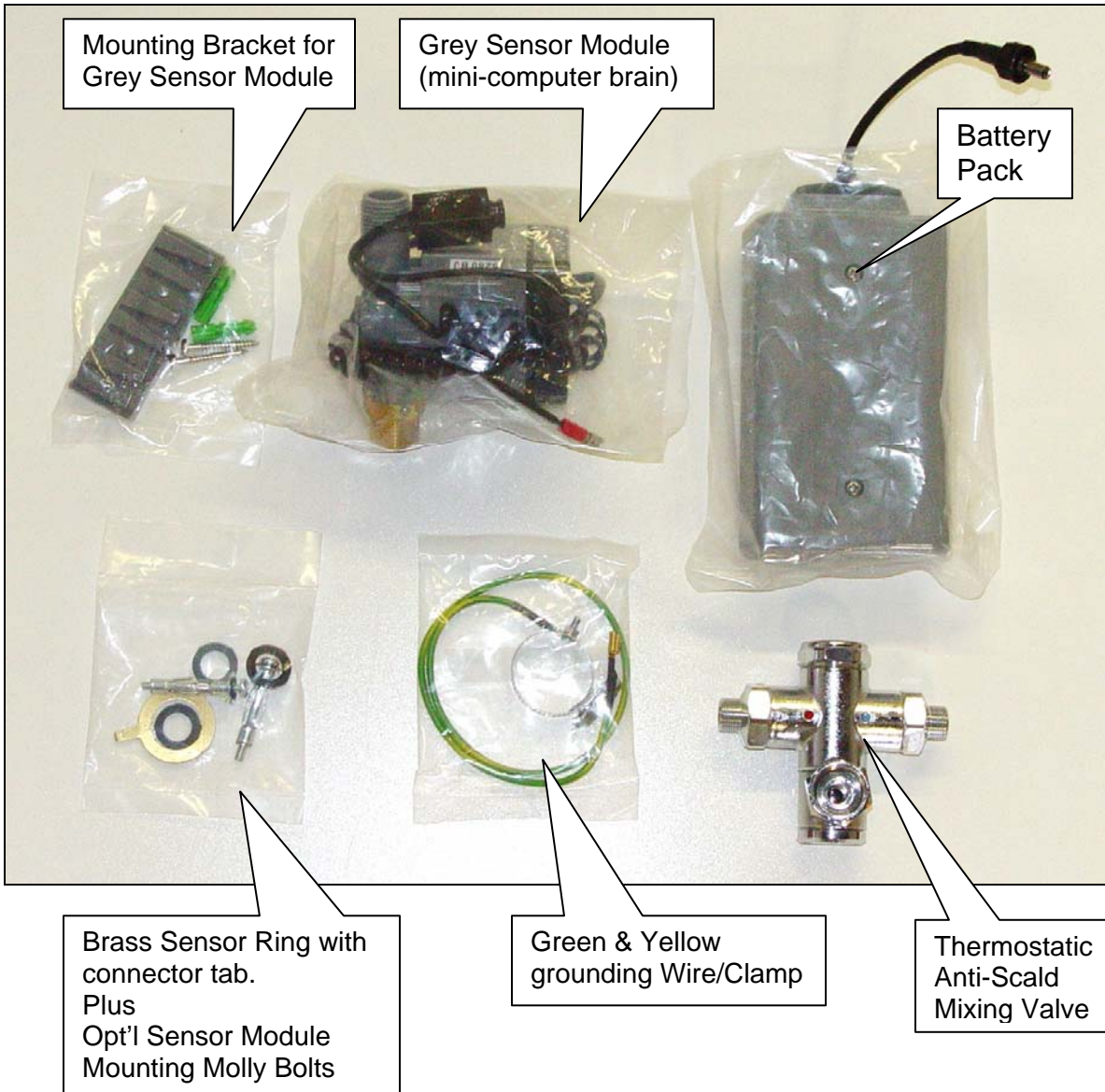

**NOTE: Four "D" Batteries Not Included**